

Connecting to ReadyTech

You can connect to your virtual machine by **Logging in to the ReadyTech Portal** and then **Connecting to the Virtual Machine**

Log in to the ReadyTech Portal

1. Use the link provided by MathWorks or copy-and-paste the URL to your browser if clicking doesn't work. (<https://axis.readytech.com/#/seat-login>)

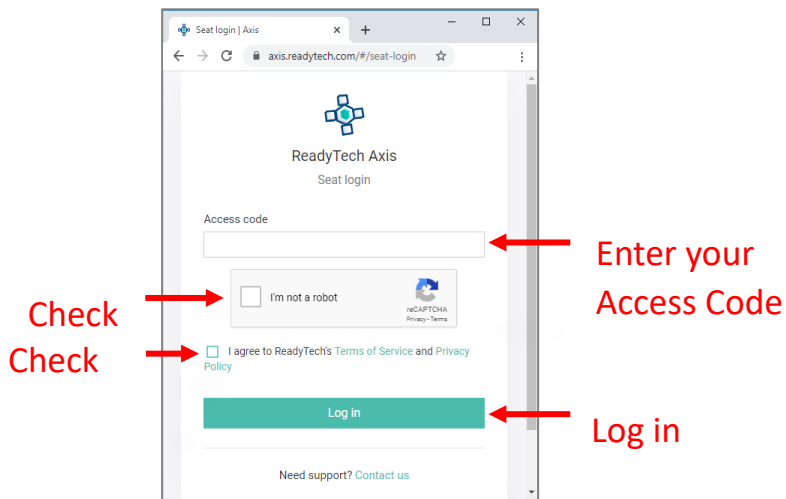

Enter your unique access code provided by MathWorks. Check off the necessary boxes and click Log in.

Connect to the Virtual Machine

Once you are logged in, you can connect to your virtual machine using your **Browser** or the **RDP**.

Option 1: Browser-based connection

1. Click **Connect to lab** and a new tab will open with the connection to the virtual machine.

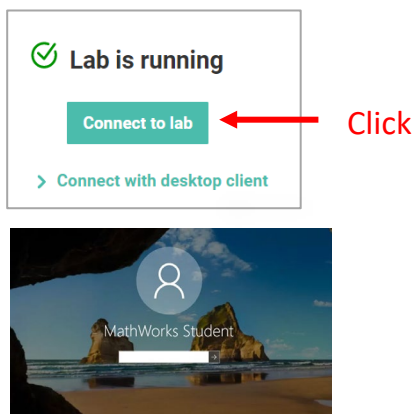

2. Enter password.

Option 2: Remote Desktop Connection (RDP)

Note: To connect with RDP you might need to disconnect from your company's VPN.

1. From the ReadyTech portal. Click **Connect with desktop client**. This will bring up more information.

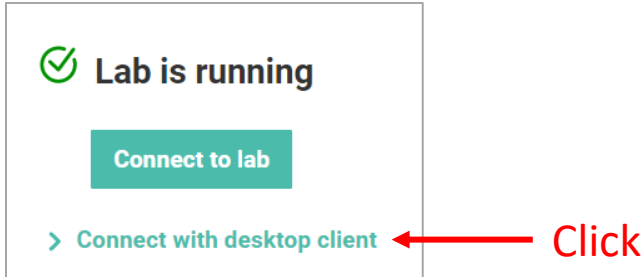

2. Copy the **Remote Address**.

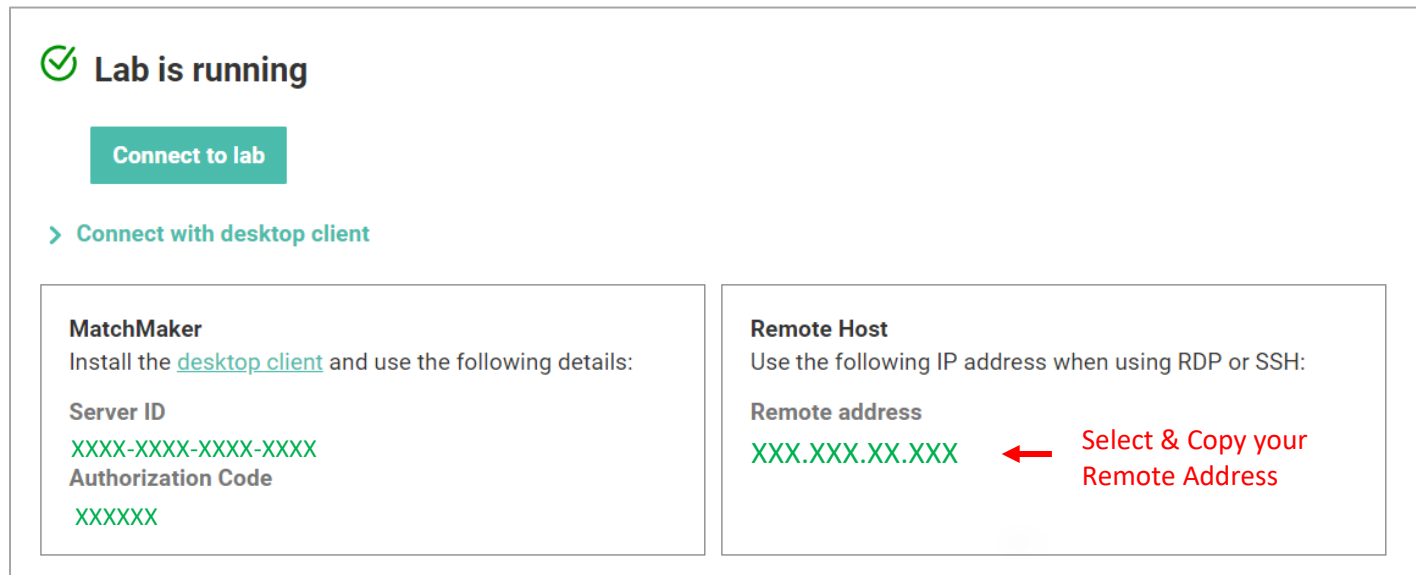

- Use the **Remote Address** in the Remote Desktop Connection App to connect to your virtual machine.

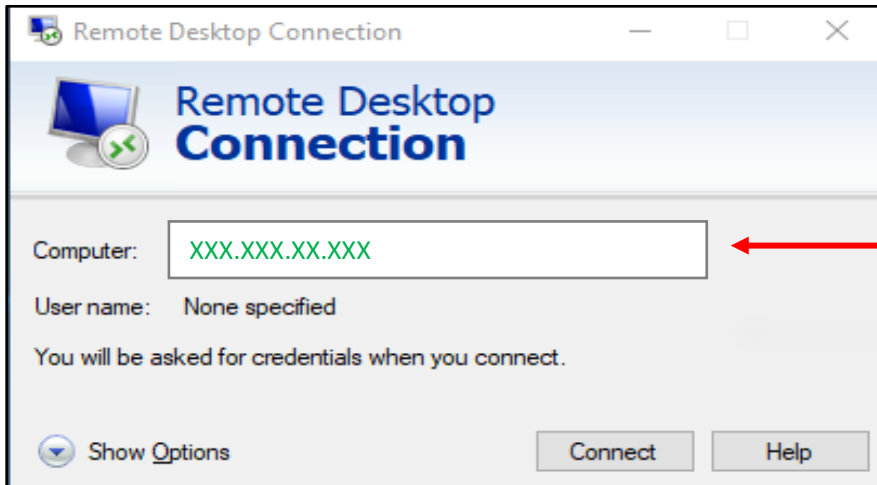

Enter your
Remote Address

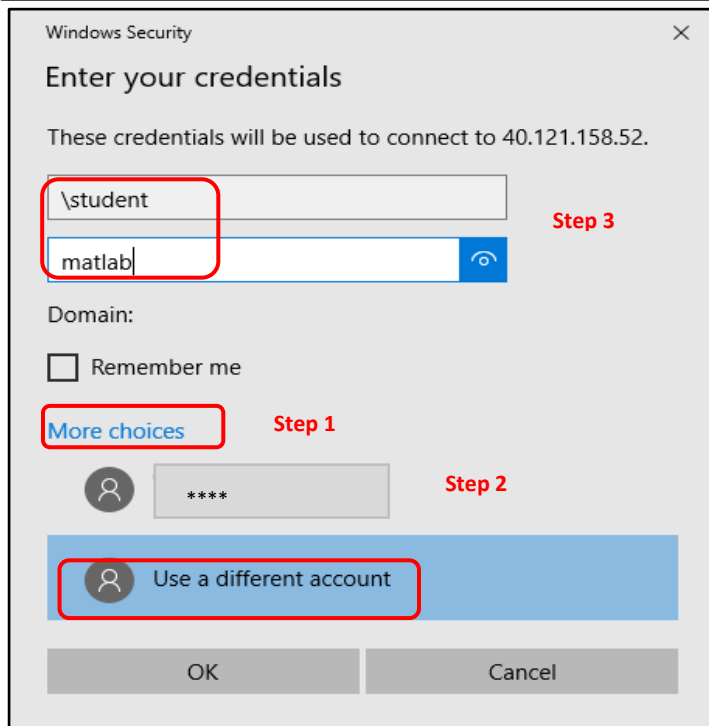

- Select '**More Choices**', click '**Use a different account**', and enter the username and password.

Username: **\student**

Password: **Enter password provided by MathWorks**